

- NOTES:
 1. MATERIAL:PHOSPHOR BRONZE
 2. FINISH: PER ES-88
 102-TIN: .000200 MICROINCHES MIN OVER COPPER
 501-GOLD: .000020 MICROINCHES MIN OVER NICKEL
 THE PRIMARY SHIPPING CARTON WILL BE LABELED
 *COMPLIANT TO RoHS DIRECTIVE 2002/95/EC & ELV
 ANNEX II OF DIRECTIVE 2003/53/EC*. CARTONS W/O
 THIS LABEL MAY CONTAIN PRODUCT WITH TIN-LEAD
 IN THE PC TAIL AREA.
 3. PRODUCT SPECIFICATION & PROCESSING PARAMETERS: NONE.
 4. DIMENSIONS GIVEN ARE BEFORE PLATING.
 5. SOLDERABILITY SPECIFICATION: SMES-152 AFTER PLATING.
 6. CAMBER SPECIFICATION: .003 MM/MM OR .003 IN/IN.
 7. BURR SPECIFICATION ES-151.
 8. RECOMMENDED PCB HOLE SPECIFICATION FOR PRESS FIT PINS:
 .062 THK. PCB
 PUNCHED HOLES: .030±.002/.762±0.05
 DRILLED HOLES: .031±.0015/.0787±0.038
 PLATED THRU HOLES: .0295±.0025/.749±0.064

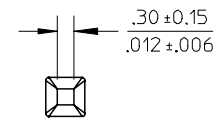
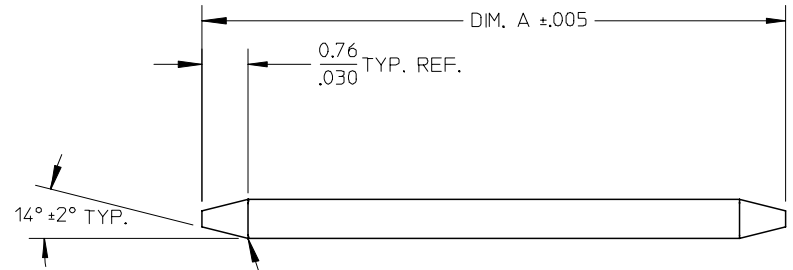

PART TO BE FREE OF ALL TOOL MARKS DUE TO COINING & TRIMMING OPERATION.

33	26.21 1.032		
31	31.75 1.250	74	31.24 1.230
30	30.48 1.200	69	20.85 .821
27	21.39 .842	68	18.29 .720
25	9.65 .380	67	16.94 .667
22	15.88 .625	66	15.49 .610
20	20.32 .800	65	14.61 .575
18	11.71 .461	64	13.08 .515
17	11.99 .472	60	10.01 .394
15	12.70 .500	58	8.56 .337
12	22.23 .875	47	19.69 .775
11	16.51 .650	46	17.86 .703
10	28.58 1.125	43	38.10 1.500
9	18.69 .736	42	13.84 .545
8	25.40 1.000	41	29.21 1.150
7	14.99 .590	40	34.93 1.375
5	11.10 .437	39	24.38 .960
4	13.46 .530	38	27.00 1.063
3	17.45 .687	37	19.05 .750
2	10.29 .405	35	23.80 .937
1	14.22 .560	34	32.26 1.270
N	DIM. A	N	DIM. A

EC NO: UCP2004-1675
 DRWN: JSCHAFFER2004/03/08
 CHK'D: 2004/03/11
 APPR: YMARGULI 2004/03/17

QUALITY SYMBOLS	GENERAL TOLERANCES (UNLESS SPECIFIED)		SCALE	DESIGN UNITS	THIRD ANGLE PROJECTION	REVISE ON CAD ONLY
	mm	INCH	8:1	INCH		
	4 PLACES	± ---	± ---	DIMENSION STYLE		TITLE
	3 PLACES	± ---	± ---	MM/IN		
	2 PLACES	± ---	± ---	DRAWN BY	DATE	
1 PLACE	± ---	± ---	SCHAFFER	2004/03/01		
ANGULAR ±1/2°			CHECKED BY	DATE	MOLEX INCORPORATED	
DRAFT WHERE APPLICABLE MUST REMAIN WITHIN DIMENSIONS			APPROVED BY	DATE	MATERIAL NO.	DOCUMENT NO.
			MARGULIS	2004/03/05	SEE CHART	SD-4166-001
THIS DRAWING CONTAINS INFORMATION THAT IS PROPRIETARY TO MOLEX INCORPORATED AND SHOULD NOT BE USED WITHOUT WRITTEN PERMISSION						SHEET NO. 1 OF *

PART NO:	ENG NO:	PART NO:	ENG NO:
08-52-1201	4166-1(102)	08-52-1233	4166-33(102)
08-52-1202	4166-2(102)	08-52-1234	4166-34(102)
08-52-1203	4166-3(102)	08-52-1235	4166-35(102)
08-52-1204	4166-4(102)	08-52-1238	4166-38(102)
08-52-1205	4166-5(102)	08-52-1239	4166-39(102)
	4166-7(102)	08-52-1241	4166-41(102)
08-52-1208	4166-8(102)	08-52-1242	4166-42(102)
08-52-1209	4166-9(102)	08-52-1243	4166-43(102)
08-52-1210	4166-10(102)	08-52-0646	4166-46(102)
08-52-1211	4166-11(102)		4166-47(102)
08-52-1212	4166-12(102)	08-52-1258	4166-58(102)
	4166-15(102)		4166-60(102)
	4166-17(102)	08-52-1264	4166-64(102)
08-52-1218	4166-18(102)		4166-65(102)
08-52-1220	4166-20(102)	08-52-1266	4166-66(102)
08-52-1222	4166-22(102)		4166-67(102)
08-52-1225	4166-25(102)		4166-68(102)
08-52-1227	4166-27(102)	08-52-1269	4166-69(102)
08-52-1230	4166-30(102)	08-52-1274	4166-74(102)
08-52-0231	4166-31(102)		

REV: AJ	SEE SHEET 1	TITLE: KK .025 SQ PIN	SHEET No. - 2 -
DOCUMENT NUMBER: SD- 4166-001		CREATED / REVISED BY: SCHAFFER	CHECKED BY: SAMIEC
APPROVED BY: MARGULIS			

PART NO:	ENG NO:	PART NO:	ENG NO:
08-52-0601	4166-1(103)	08-52-0633	4166-33(103)
08-52-0602	4166-2(103)		4166-34(103)
08-52-0603	4166-3(103)	08-52-0635	4166-35(103)
08-52-0604	4166-4(103)		4166-38(103)
08-52-0605	4166-5(103)		4166-39(103)
	4166-7(103)		4166-41(103)
08-52-0608	4166-8(103)		4166-42(103)
08-52-0609	4166-9(103)		4166-43(103)
08-52-0610	4166-10(103)		4166-46(103)
08-52-0611	4166-11(103)		4166-47(103)
08-52-0612	4166-12(103)		4166-58(103)
08-52-0615	4166-15(103)	08-52-0660	4166-60(103)
	4166-17(103)		4166-64(103)
	4166-18(103)		4166-65(103)
	4166-20(103)		4166-66(103)
	4166-22(103)		4166-67(103)
	4166-25(103)		4166-68(103)
	4166-27(103)		4166-69(103)
08-52-0630	4166-30(103)		4166-74(103)
	4166-31(103)		

PART NO:	ENG NO:	PART NO:	ENG NO:
08-52-1301	4166-1(121)		4166-33(121)
08-52-1302	4166-2(121)		4166-34(121)
08-52-1303	4166-3(121)		4166-35(121)
08-52-1304	4166-4(121)		4166-38(121)
08-52-1305	4166-5(121)		4166-39(121)
08-52-1307	4166-7(121)		4166-41(121)
	4166-8(121)	08-52-1342	4166-42(121)
08-52-1309	4166-9(121)		4166-43(121)
	4166-10(121)		4166-46(121)
08-52-1311	4166-11(121)		4166-47(121)
	4166-12(121)		4166-58(121)
08-52-1315	4166-15(121)		4166-60(121)
08-52-1317	4166-17(121)		4166-64(121)
	4166-18(121)	08-52-1365	4166-65(121)
	4166-20(121)		4166-66(121)
08-52-1322	4166-22(121)	08-52-1367	4166-67(121)
	4166-25(121)	08-52-1368	4166-68(121)
08-52-1327	4166-27(121)	08-52-1369	4166-69(121)
	4166-30(121)		4166-74(121)
	4166-31(121)		

REV: AJ	SEE SHEET 1	TITLE: KK .025 SQ PIN	SHEET No. - 3 -
DOCUMENT NUMBER: SD- 4166-001	CREATED / REVISED BY: SCHAFFER	CHECKED BY: SAMIEC	APPROVED BY: MARGULIS

PART NO:	ENG NO:	PART NO:	ENG NO:
	4166-1(125)		4166-33(125)
	4166-2(125)		4166-34(125)
	4166-3(125)		4166-35(125)
	4166-4(125)		4166-38(125)
08-59-0605	4166-5(125)		4166-39(125)
	4166-7(125)		4166-41(125)
	4166-8(125)		4166-42(125)
08-59-0609	4166-9(125)		4166-43(125)
	4166-10(125)		4166-46(125)
	4166-11(125)		4166-47(125)
	4166-12(125)		4166-58(125)
	4166-15(125)		4166-60(125)
	4166-17(125)		4166-64(125)
	4166-18(125)		4166-65(125)
	4166-20(125)		4166-66(125)
	4166-22(125)		4166-67(125)
	4166-25(125)		4166-68(125)
	4166-27(125)		4166-69(125)
	4166-30(125)		4166-74(125)
	4166-31(125)		

PART NO:	ENG NO:	PART NO:	ENG NO:
	4166-1(126)		4166-33(126)
08-60-0602	4166-2(126)		4166-34(126)
	4166-3(126)		4166-35(126)
	4166-4(126)		4166-38(126)
	4166-5(126)		4166-39(126)
	4166-7(126)		4166-41(126)
	4166-8(126)		4166-42(126)
	4166-9(126)		4166-43(126)
	4166-10(126)		4166-46(126)
	4166-11(126)		4166-47(126)
	4166-12(126)		4166-58(126)
	4166-15(126)		4166-60(126)
	4166-17(126)		4166-64(126)
	4166-18(126)		4166-65(126)
	4166-20(126)		4166-66(126)
	4166-22(126)		4166-67(126)
	4166-25(126)		4166-68(126)
	4166-27(126)		4166-69(126)
	4166-30(126)		4166-74(126)
	4166-31(126)		

REV: AJ	SEE SHEET 1	TITLE: KK .025 SQ PIN	SHEET No. - 4 -
DOCUMENT NUMBER: SD- 4166-001	CREATED / REVISED BY: SCHAFFER	CHECKED BY: SAMIEC	APPROVED BY: MARGULIS

PART NO:	ENG NO:	PART NO:	ENG NO:
08-52-0711	4166-1(224)		4166-33(224)
	4166-2(224)		
	4166-3(224)		4166-35(224)
	4166-4(224)		4166-38(224)
	4166-5(224)		4166-39(224)
	4166-7(224)		4166-41(224)
	4166-8(224)		4166-42(224)
	4166-9(224)		4166-43(224)
	4166-10(224)		4166-46(224)
	4166-11(224)		4166-47(224)
	4166-12(224)		4166-58(224)
	4166-15(224)		4166-60(224)
			4166-64(224)
	4166-18(224)		4166-65(224)
	4166-20(224)		4166-66(224)
	4166-22(224)		4166-67(224)
	4166-25(224)		4166-68(224)
08-52-0727	4166-27(224)		4166-69(224)
	4166-30(224)		4166-74(224)
	4166-31(224)		

PART NO:	ENG NO:	PART NO:	ENG NO:
08-58-0611	4166-1(501)	08-58-0633	4166-33(501)
	4166-2(501)	08-58-0634	4166-34(501)
08-58-0613	4166-3(501)	08-58-0635	4166-35(501)
	4166-4(501)		4166-38(501)
	4166-5(501)		4166-39(501)
	4166-7(501)	08-58-0641	4166-41(501)
08-58-0668	4166-8(501)		4166-42(501)
	4166-9(501)	08-58-0643	4166-43(501)
	4166-10(501)		4166-46(501)
	4166-11(501)		4166-47(501)
08-58-0612	4166-12(501)		4166-58(501)
	4166-15(501)		4166-60(501)
08-58-0614	4166-17(501)		4166-64(501)
08-58-0608	4166-18(501)		4166-65(501)
08-58-0646	4166-20(501)		4166-66(501)
08-58-0688	4166-22(501)		4166-67(501)
	4166-25(501)		4166-68(501)
	4166-27(501)		4166-69(501)
08-58-0630	4166-30(501)	08-58-0674	4166-74(501)
08-58-0631	4166-31(501)		

REV: AJ	SEE SHEET 1	TITLE: KK .025 SQ PIN	SHEET No. - 5 -
DOCUMENT NUMBER: SD- 4166-001	CREATED / REVISED BY: SCHAFFER	CHECKED BY: SAMIEC	APPROVED BY: MARGULIS

PART NO:	ENG NO:	PART NO:	ENG NO:
	4166-1(503)		4166-33(503)
08-58-0622	4166-2(503)	08-58-0690	4166-34(503)
	4166-3(503)	08-58-0636	4166-35(503)
	4166-4(503)		4166-38(503)
08-58-0605	4166-5(503)		4166-39(503)
08-58-0607	4166-7(503)		4166-41(503)
08-58-0658	4166-8(503)		4166-42(503)
	4166-9(503)		4166-43(503)
	4166-10(503)		4166-46(503)
	4166-11(503)		4166-47(503)
	4166-12(503)		4166-58(503)
	4166-15(503)		4166-60(503)
08-58-0617	4166-17(503)		4166-64(503)
08-58-0618	4166-18(503)		4166-65(503)
	4166-20(503)		4166-66(503)
	4166-22(503)		4166-67(503)
08-58-0625	4166-25(503)		4166-68(503)
	4166-27(503)		4166-69(503)
	4166-30(503)		4166-74(503)
	4166-31(503)		

PART NO:	ENG NO:	PART NO:	ENG NO:
	4166-1(505)		4166-33(505)
08-58-0652	4166-2(505)		4166-34(505)
	4166-3(505)		4166-35(505)
	4166-4(505)		4166-38(505)
	4166-5(505)		4166-39(505)
	4166-7(505)		4166-41(505)
	4166-8(505)		4166-42(505)
	4166-9(505)		4166-43(505)
	4166-10(505)		4166-46(505)
	4166-11(505)		4166-47(505)
	4166-12(505)		4166-58(505)
	4166-15(505)		4166-60(505)
	4166-17(505)		4166-64(505)
	4166-18(505)		4166-65(505)
	4166-20(505)		4166-66(505)
	4166-22(505)		4166-67(505)
	4166-25(505)		4166-68(505)
	4166-27(505)		4166-69(505)
	4166-30(505)		4166-74(505)
	4166-31(505)		

REV: AJ	SEE SHEET 1	TITLE: KK .025 SQ PIN	SHEET No. - 6 -
DOCUMENT NUMBER: SD- 4166-001	CREATED / REVISED BY: SCHAFFER	CHECKED BY: SAMIEC	APPROVED BY: MARGULIS

PART NO:	ENG NO:	PART NO:	ENG NO:
	4166-1(516)	08-58-0653	4166-33(516)
	4166-2(516)		4166-34(516)
	4166-3(516)	08-58-0682	4166-35(516)
	4166-4(516)		4166-38(516)
08-58-0655	4166-5(516)		4166-39(516)
	4166-7(516)		4166-41(516)
	4166-8(516)		4166-42(516)
	4166-9(516)		4166-43(516)
	4166-10(516)		4166-46(516)
	4166-11(516)		4166-47(516)
	4166-12(516)		4166-58(516)
	4166-15(516)		4166-60(516)
	4166-17(516)		4166-64(516)
	4166-18(516)		4166-65(516)
	4166-20(516)		4166-66(516)
	4166-22(516)		4166-67(516)
	4166-25(516)		4166-68(516)
	4166-27(516)		4166-69(516)
08-58-0654	4166-30(516)		4166-74(516)
	4166-31(516)		

PART NO:	ENG NO:	PART NO:	ENG NO:
	4166-1(518)		4166-33(518)
	4166-2(518)		4166-34(518)
	4166-3(518)		4166-35(518)
	4166-4(518)		4166-38(518)
08-58-0626	4166-5(518)		4166-39(518)
08-58-0627	4166-7(518)		4166-41(518)
	4166-8(518)		4166-42(518)
	4166-9(518)		4166-43(518)
	4166-10(518)		4166-46(518)
	4166-11(518)		4166-47(518)
	4166-12(518)		4166-58(518)
	4166-15(518)		4166-60(518)
08-58-0637	4166-17(518)		4166-64(518)
	4166-18(518)		4166-65(518)
	4166-20(518)		4166-66(518)
	4166-22(518)		4166-67(518)
08-58-0645	4166-25(518)		4166-68(518)
	4166-27(518)		4166-69(518)
	4166-30(518)		4166-74(518)
	4166-31(518)		

REV: AJ	SEE SHEET 1	TITLE: KK .025 SQ PIN	SHEET No. - 7 -
DOCUMENT NUMBER: SD- 4166-001	CREATED / REVISED BY: SCHAFFER	CHECKED BY: SAMIEC	APPROVED BY: MARGULIS

PART NO:	ENG NO:	PART NO:	ENG NO:
	4166-1(531)		4166-33(531)
	4166-2(531)		4166-34(531)
	4166-3(531)		4166-35(531)
	4166-4(531)	08-58-0838	4166-38(531)
	4166-5(531)		4166-39(531)
08-58-0687	4166-7(531)		4166-41(531)
	4166-8(531)		4166-42(531)
	4166-9(531)		4166-43(531)
	4166-10(531)		4166-46(531)
08-58-0811	4166-11(531)		4166-47(531)
	4166-12(531)		4166-58(531)
	4166-15(531)		4166-60(531)
	4166-17(531)		4166-64(531)
	4166-18(531)		4166-65(531)
	4166-20(531)	08-58-0676	4166-66(531)
08-58-0689	4166-22(531)		4166-67(531)
	4166-25(531)		4166-68(531)
	4166-27(531)		4166-69(531)
	4166-30(531)		4166-74(531)
	4166-31(531)		

REV: AJ	SEE SHEET 1	TITLE: KK .025 SQ PIN	SHEET No. - 8 -
DOCUMENT NUMBER: SD- 4166-001		CREATED / REVISED BY: SCHAFFER	CHECKED BY: SAMIEC
		APPROVED BY: MARGULIS	