

## Hospital-Grade Extension Cord, NEMA 5-15P to NEMA 5-15R - Green Dot, 13A, 125V, 16 AWG, 2 ft., Gray

MODEL NUMBER: P022-002-GY-HG

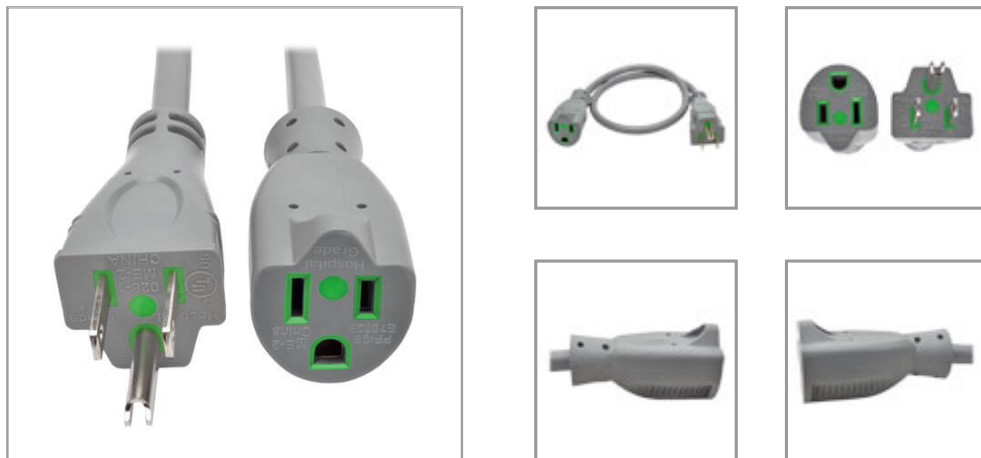

Hospital-grade extension cord connects two devices with 5-15P-HG/5-15R-HG power connectors in a hospital or other medical facility.

### Features

#### Hospital-Grade Extension Cord is a Safe Solution for Medical Facilities

This hospital-grade power cord is designed for computers, mobile carts, printers, scanners, monitors and other compatible hospital equipment within a healthcare facility. It features a NEMA 5-15R-HG end for connecting to a device and a NEMA 5-15P-HG plug for connecting to a hospital-grade AC power source located outside patient-care vicinities. The two-foot length helps reduce cable clutter and minimize the risk of tripping.

#### Designed and Tested to Strict Hospital-Grade Standards

This cord is tested to ANSI/UL 62 and 817 standards, as well as CAN/CSA C22.2 no. 21 and 49 standards, ensuring it's a dependable power solution for hospital environments.

#### Color-Coded to Avoid Misidentification That Can Cause Costly Downtime

This extension cord features a gray SJT jacket and fully molded gray ends. The color-coding allows easy, fast identification in a crowded surge protector and helps prevent the cable from becoming inadvertently disconnected.

### Highlights

- Recommended for connecting devices to power outlets outside patient-care vicinities
- Adds 2 ft. to your existing power connection to provide flexibility in placing devices
- Medical power cord replaces or upgrades power cord provided by manufacturer
- 5-15P-HG plug connects to AC power; 5-15R-HG end connects to device's input cord
- Color-coded gray for fast, easy identification in a crowded PDU, UPS or surge protector

### Applications

- Connect devices like PCs, mobile carts, monitors and printers to a power outlet up to 2 ft. away in a hospital environment outside patient-care vicinities
- Extend an existing power connection up to 2 ft. to more easily place a device or reach a power source
- Update or replace the standard power cord provided by a device's original manufacturer

### Package Includes

- P022-002-GY-HG Hospital-Grade Extension Cord, 5-15P-HG to 5-15R-HG, 2 ft., Gray

## Specifications



**Tripp Lite**  
1111 W. 35th Street  
Chicago, IL 60609 USA  
Telephone: 773.869.1234  
www.tripplite.com

<b>OVERVIEW</b>	
UPC Code	037332200099
Country/Region	North America
Power Cord Application	PC; Monitor; Server; PDU; UPS; Mobile Cart
<b>INPUT</b>	
Maximum Input Amps	13
Cable Length (ft.)	2
Cable Length (m)	0.6
Voltage Compatibility (VAC)	125
<b>PHYSICAL</b>	
Power Cord Jacket Type	SJT
Wire Gauge (AWG)	16
Wire Gauge (OD - mm <sup>2</sup> )	1.31
Shipping Dimensions (hwd / in.)	9.50 x 6.50 x 0.50
Shipping Dimensions (hwd / cm)	24.13 x 16.51 x 1.27
Shipping Weight (lbs.)	0.20
Shipping Weight (kg)	0.09
Color	Gray
Number of Conductors	3
<b>CONNECTIONS</b>	
Side A - Connector 1	NEMA 5-15P
Side B - Connector 1	NEMA 5-15R
<b>CERTIFICATIONS</b>	
Certifications	ANSI/UL 62 AND 817, CAN/CSA C22.2 NO. 21 AND 42, RoHS, REACH
<b>WARRANTY</b>	
Product Warranty Period (Worldwide)	Lifetime limited warranty

© 2018 Tripp Lite. All rights reserved. All product and company names are trademarks or registered trademarks of their respective holders. Use of them does not imply any affiliation with or endorsement by them. Tripp Lite has a policy of continuous improvement. Specifications are subject to change without notice. Tripp Lite uses primary and third-party agencies to test its products for compliance with standards. See a list of Tripp Lite's testing agencies: <https://www.tripplite.com/products/product-certification-agencies>